

OPERATOR'S MANUAL

CELLU M6 INFINITY®



PLEASE READ THE COMPLETE MANUAL CAREFULLY
BEFORE USING YOUR EQUIPMENT.

© Copyright 2024. LPG®, and CELLU M6 INFINITY® are registered trademarks of LPG®.
Any reproduction, even partial, is strictly prohibited.

GU2402-EN Edition A1



Congratulations on the purchase of your CELLU M6 INFINITY®. This model represents the fruits of many years of experience in the design and production of cutaneous tissue treatment systems. You will experience fully the technical perfection and reliability of LPG Systems, which is the leader in this sector. With the aim to continuously provide satisfaction, your device is equipped with a specific software devised to ensure connection with the LPG Systems dedicated server. The data collected through this software will allow LPG Systems to give you better services in respect of support and maintenance.

This operator's manual contains the operating description, basic maintenance instructions to be performed periodically and the safety instructions. Your device is intended for use in the treatment of connective tissue. It should be used only by a professional who has attended the manufacturer's training provided by LPG Systems or an approved provider, if you live outside of France. If you have any doubts whatsoever concerning the operation or maintenance of your equipment, please do not hesitate to contact LPG Systems via the Customer Service Department of your distributor. **+33 (0)4 75 78 69 00**

WARNING

In order to respond better to customer requirements and expectations, LPG Systems is continuously researching ways of improving the design and quality of its products. This will explain the few minor differences between your equipment and the item described in this guide.

PACKAGE CONTENT

- > One CELLU M6 INFINITY® device
- > One INFINITY 80 IW™ head
- > One TR-30 IW™ head
- > One Ergolift IW™ head
- > Two Ergolift® chambers (Lift 20 and Lift 10)
- > One electrical power cord
- > One marketing set

LIST OF HEAD OF CARE PROVIDED WITH YOUR DEVICE:

Depending on the version you have, (see serial number on the nameplate), some protocols are not activated, and their accessories are not provided. Accordingly, the paragraphs describing them do not concern this version (see table below).

In any doubt about the operation of your unit or to evolve into a complete model, please contact the Customer Service of LPG Systems or your distributor

	CELLU M6 INFINITY®	CELLU M6 INFINITY® PREMIUM
INFINITY 80 IW™	●	●
TR-30 IW™	●	●
Ergolift IW™		●

WARNING

The interface user manual and the unpacking and quick installation instructions are available in electronical format at <https://www.lpg-group.com/fr/user-guides>.

TABLE OF CONTENTS

1	DESCRIPTION OF THE DEVICE	4
2	CONTROLS DESCRIPTION	7
3	CASTERS	10
4	MAINTENANCE	15
5	OPERATING ANOMALIES	22
6	TECHNICAL SPECIFICATION	23
7	TREATMENT HEAD	24
8	ENDERMOWEAR®	32
9	GUARANTEE	33

WARNING

The manufacturer reserves the right to amend the product technical specifications without prior notice. Any reproduction – even in part – is prohibited. All the illustrations in this operator's manual are non-binding.

DESCRIPTION OF THE DEVICE

INTENDED USE

The **CELLU M6 INFINITY®** device is intended for aesthetic uses to body and face care.

It can be used to:

- 1.** Smooth the body's contour
- 2.** Redesign of silhouette
- 3.** Firming the skin
- 4.** Reduce wrinkles
- 5.** Enhance the skin aspect
- 6.** Face contouring

OPERATING PRINCIPLES

The operating principles of the CELLU M6 INFINITY® device consist of a suction force coupled with movements of rolls/valves, performed with treatment heads. These heads are placed on the healthy skin of the patient and then moved across the area to be treated by the professional who has been trained by LPG Systems.

CELLU M6 INFINITY®

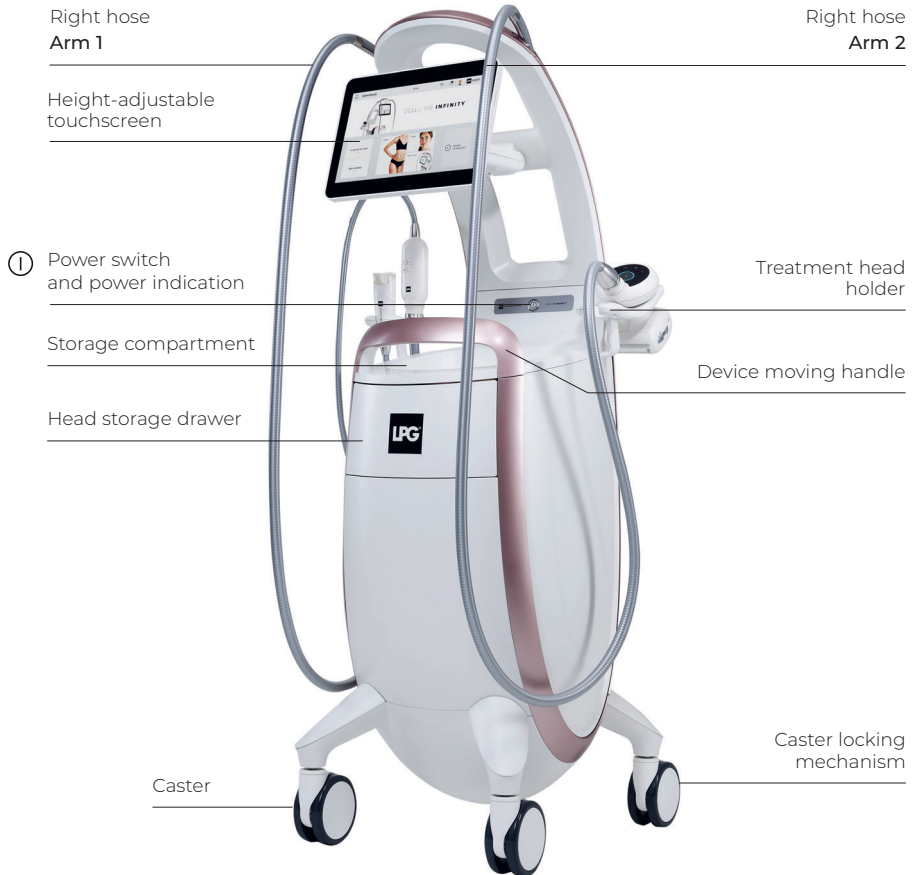

WARNING

The unit can only operate if it is connected to the mains by its power cord and provided the ON switch has been activated and the green voltage light is on. After switching on the unit, please wait a few seconds for the screen to display information.

Filter access door



Power switch

Identification plate



> Before use, please unwind the power cord completely.

ACCESSING THE FILTERS

The filters are accessible via the back of the unit.



Arm 2 filter

Arm 1 filter

CONTROLS DESCRIPTION

CONTROL SCREEN



Touch screen

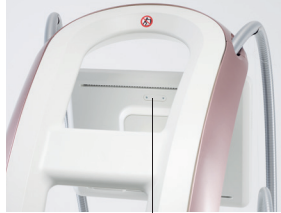

USB port access

INFINITY 80 IW™ CARE HEAD



Parameter selection button

On/Off button

Parameter settings

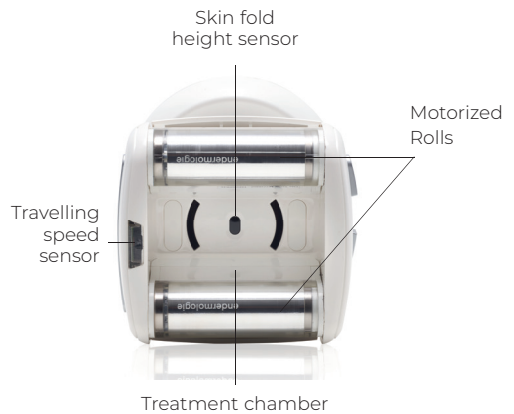

Skin fold height sensor

Motorized Rolls

Travelling speed sensor

Treatment chamber

TR-30 IW™ CARE HEAD



ERGOLIFT IW™ CARE HEAD ADAPTATER



Ergolift chamber connection

DESCRIPTION OF ERGOLIFT IW™ CHAMBERS



> LIFT 10 :

For the care to tight areas, eyes and lip contour, hands and fingers



> LIFT 20 :

For the care of large areas with fine tissues, and sensible areas



Only the Lift 20 and Lift 10 chambers can be connected to the ergolift IW™ head. They can be connected and disconnected by a simple push/pull action.

CASTERS

The CELLU M6 INFINITY® device is equipped with locking casters. Please follow the procedure indicated below to lock or unlock the casters:



Unlocked



Locked

WARNING

It is possible during prolonged immobilisation of the device, that marks form on your floor at the location of the wheels. This phenomenon is the result of a chemical reaction between the components of some flooring and those of the wheels of the CELLU M6 INFINITY®.

IMPORTANT SAFETY INFORMATION

IMPORTANT SAFETY INFORMATION

All safety precautions must be observed whilst using electrical equipment. Please read all safety notices and precautions prior to use of the equipment.

DANGER - TO MINIMISE THE RISK OF ELECTRICAL SHOCK:

- Always disconnect the equipment from the electrical supply outlet after use and before cleaning and maintenance.
- Check that the voltage of the appliance indicated on the nameplate corresponds to the rated voltage of the AC outlet.
- The appliance must be connected via the supplied mains cord to a grounded wall socket with current electrical standards. No AC adapter should be used with this appliance.
- Ensure that the appliance is connected to a system that has differential protection against direct and alternating currents and is designed to protect persons from the hazards of electrification and the equipment from overvoltages and short circuits. The means of protection must have a differential sensitivity of 30 mA.
- Risk of electric shock when the appliance is used without a grounded connection.

WARNING

TO MINIMISE THE RISK OF BURNS, FIRE, ELECTRIC SHOCK, OR INJURY TO THE PERSON:

- A device should never be left unattended while plugged in.
 - Unplug it when not in use for a long time or before putting on or removing parts.
 - It is necessary to carefully supervise the appliance when used by, on, or near children or persons with disabilities.
 - Do not use the device for any purpose other than those recommended by LPG Systems. Do not use parts not recommended by LPG Systems.
-

-
- Never use this appliance if the power cord or plug is damaged, if it is not working properly, if it has been dropped or damaged, or if it has been exposed to excessive moisture.
 - Do not move the appliance by pulling on the power cord.
 - Move the device using the moving handle
 - Fully unwind the power cord and keep it away from hot surfaces.
 - Never use the unit if the vents are obstructed. Make sure to keep openings free of dust and the like.
 - Never drop or insert an object into an opening, do not suck up solid or liquid bodies, which will damage the appliance.
 - Do not use the appliance on dusty, tilted ground, in a humid environment, or exposed to the elements.
 - Do not use in the presence of aerosol products (sprays) or oxygen.
 - To unplug the unit, turn all controls to the off position and then unplug the unit. The device is disconnected by disconnecting the AC outlet.
 - You may not modify your device without the prior permission of LPG Systems.
 - It is forbidden to use components or spare parts not qualified by LPG Systems.
 - Return the unit to the LPG Systems service center for examination and repair.
 - Children should not play with the device.
 - Cleaning and maintenance should not be carried out by unsupervised children.
 - The INFINITY 80 IW™ treatment head is equipped with a class 1 laser at the skin fold height sensor. It should not be observed directly or with the help of an optical instrument.

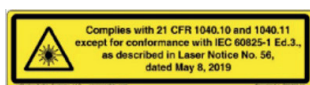

PRECAUTIONS FOR USE

WARNING : KEEP THESE INSTRUCTIONS.

Your device is intended for use on undamaged skin. It is important to read and follow all the following precautions and contraindications before using your device

- Never touch the customer and unprotected cables or connections on the device at the same time.
- Do not use the adapter as a treatment head, in direct contact with the skin.
- Use only the treatment heads supplied with your device or recommended by LPG Systems.
- The user is solely responsible for the care and advice provided to his customers. The care and provision of care by the user or within his or her structure rests solely with the user and is left to his or her free discretion. Consequently, LPG Systems cannot be held responsible for any inappropriate use, any inappropriate protocol and/or care, any contraindication not respected and any inadequate care by the user.
- Improper use of the device may cause pain or tissue damage.
- The user should be particularly attentive to the sensations of the person being treated.
- The user must ensure that the parameters (intensity, sequentiality, differential, etc.) are always adapted to the tissues to be treated.
- Do not lean on, rest or sit on the device.
- When crossing a threshold or step, it is advisable to move the device gently by holding the handle firmly to avoid any risk of tipping over.
- Do not move the device by grabbing it by the screen.
- Do not use the USB socket during the treatment.
- Do not operate the appliance outside specified environmental limits (see technical specifications).
- The mains plug is used as a disconnecting device. The device is disconnected by disconnecting the mains plug.
- Make sure to position your device so that the AC plug is always accessible.
- Do not touch the customer and the hose connectors at the same time.
- Do not apply vegetable oil to the treatment heads.
- Do not place objects under the device
- Do not obstruct the air outlets.

WARNING

Europe VII-H05VVF3G1,50-C19; Italy I/3/16-H05VVF3G1,50-C19; Switzerland 23G-H05VVF3G1.50-C19; UK BS13/13-H05VVF3G1,50-C19; Japan 498GJ-VCTF3X2.00-C19.

CONTRAINDICATIONS

- Do not treat open wounds, eyes, intracavitary areas, mucous membranes, genitals, nipples. This device is not recommended for pregnant women. In case of pregnancy, do not treat the lumbo-abdominal region, seek the advice of the attending physician before any treatment.
- Do not treat a client/patient with an infectious pathology, a progressive tumor, phlebitis, a wound or an infected area.
- Do not treat a client with cancer, a tumor or other cancerous lesions. If there is a history of tumour and remission, seek the advice of the attending physician.
- Do not treat inflammatory areas or scars following recent surgery without medical advice and training in the LPG® technique in the field concerned.
- Do not treat people with circulatory disorders, without first seeking the advice of the attending physician and without training in the LPG® technique in the field concerned.
- Do not treat a client who presents with unexplained and persistent pain without medical advice and training in the LPG® technique in the relevant field.
- Do not treat a client after invasive medical care without the advice of the doctor or surgeon who performed the treatment and without training in the LPG® technique in the area being treated.
- To avoid the risk of bruising, exercise caution in accordance with a client's level of sensitivity.
- Stop treatment immediately if the client/patient is experiencing pain and refer the client/patient to a doctor.
- This device should not be used on any dermatoses, rashes, herpes, inflammatory or infected acne, vitiligo. Consult a doctor.
- Do not use this device on people with blood diseases
- Due to the potential for interference, it is important for the professional to ensure that the client does not have a personal medical device, such as a pacemaker. If so, obtain details about the device in question to ensure that any interference will not affect the correct functioning of the device.
- As this list is not exhaustive, always seek the advice of the attending physician in case of doubt.

WARNING

This device contains programmes designed to guide the user in obtaining the best expected results for each case treated. In no way are they a guarantee of the success of the treatment, which varies according to the morphology, physiology and eating behaviour of each client/patient.

ELECTROMAGNETIC COMPATIBILITY

- Your **CELLU M6 INFINITY®** device requires special precautions with regard to EMC, it must be installed and commissioned according to the information provided in this user guide.
- RF handheld communications devices (including peripherals such as antenna cables and external antennas) should not be used closer than 30 cm (12 inches) to any part of your **CELLU M6 INFINITY®** device, including cables specified by the manufacturer. Otherwise, the performance of these devices could be impaired.
- The use of other treatment heads than those provided by LPG Systems may result in increased emissions or decreased immunity of your device.
- The use of accessories, transducers, and cables other than those specified or supplied with your **CELLU M6 INFINITY®** device may cause increased electromagnetic emissions or decreased immunity from that device and may cause improper operation.
- You should avoid using your **CELLU M6 INFINITY®** device next to or stacked with other devices because this can cause malfunction. If this use is necessary, this and other devices should be observed to verify their normal operation.
- Your **CELLU M6 INFINITY®** device does not handle critical performance.
- Interference may occur in the vicinity of devices marked with the following symbol:



WARNING

This device contains programmes designed to guide the user in obtaining the best expected results for each case treated. In no way are they a guarantee of the success of the treatment, which varies according to the morphology, physiology and eating behaviour of each client/patient.

IDENTIFICATION PLATE

Your device can be identified by a serial number on the nameplate.

This also indicates the supply voltage of the device. When contacting LPG Systems customer service with a technical issue, please include the serial numbers of your **CELLU M6 INFINITY®** device. This serial number tells you about the year and month your device was manufactured. The letter gives the year of manufacture: AO= 2024 AP= 2025... While the two digits indicate the month of production: 01= January, 02= February, 03= March...

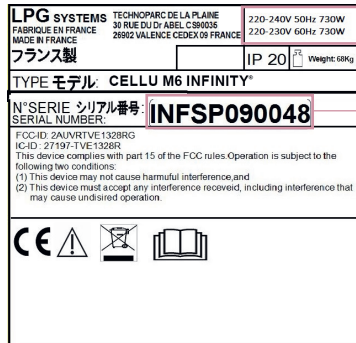

Voltage, frequency and power

Serial number



This icon means that the device was put on the market after August 13, 2006. In accordance with Directive 2002/96/EC, it cannot be disposed of with conventional household waste and must be subject to appropriate separate collection. When your device is at the end of its life, you should contact Recylum who will advise you on the most appropriate collection solution (www.recylum.com). In this way, you will be doing something for the environment and contributing to the preservation of natural resources.



This icon means to consult the accompanying documents before using your device.



This icon means that some specific warnings or precautions associated with this device are not on the label.



This icon means fragile, to be handled with care



This icon means to keep upright



This icon means not to spill



This icon means to store away from inclement weather



This icon signifies temperature limits



This icon means relative humidity limit



This icon stands for atmospheric pressure limit

DEVICE CLEANING

It is advisable to clean your device as often as possible, not only for hygiene and aesthetic reasons but also because this cleaning helps to keep it in good working order and extend its life. It is necessary to clean it after each use with a damp, non-abrasive sponge.

Using a vacuum cleaner and a fine nozzle, clean the following parts:

- Inside drawer for head storage.
- Inside the storage compartment

Using a damp sponge, clean the following parts:

- All outer covers.
- Hoses.

WARNING

The nameplate of your device may change. The one that's approved is the one that's affixed to your device. The voltage and the frequency depend on the reference of your device, refer to chapter 6. Your device cannot be thrown away with standard household waste but must be disposed of by means of recycling. When your device reaches the end of its useful life, it must be brought to an appropriate recycling center or returned to your dealer. By doing so, you help the environment by contributing to the conservation of natural resources and the protection of human health.

Using a cloth soaked in a little alcohol-free household product, clean the following parts:

- Inside the head storage drawer.
- The storage compartment.
- Inside the filter access door.

Using a soft cloth or antistatic wipes, clean:

- The touch panel

Treatment heads should be cleaned before first use, refer to the chapter «Care heads».

FILTER CARTRIDGES REPLACEMENT

Your device contains 2 filter cartridges. This components guarantee the efficiency of your device and prolongs its useful life.

You must replace your filter cartridges as soon as a notification appears on the homepage of your device (fig.1)

Click on the “Change now” notification to access the Maintenance screen or select the “Maintenance” menu in the settings (fig.2)

The «maintenance» screen indicates the filter that needs to be replaced (fig. 3).

Once, your filter cartridge is replaced, you must initialize its filter counter by pressing the «I have changed the filter» button (fig. 4).



Fig 1

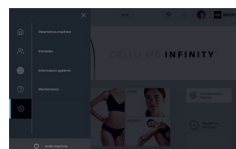

Fig 2

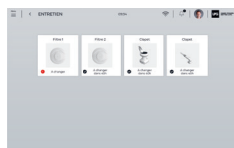

Fig 3



Fig 4

WARNING

Proscribe aggressive products such as acetone, trichloroethylene or alcohol at 90°.

To replace your filter cartridges, follow the steps below:

1. Open the filter access hatch by applying impulse pressure at the symbol located halfway up the hatch (fig.1)
2. Unscrew the filter cartridges and replace them with new ones (fig.2 and fig.3)
3. When your filter cartridge is replaced, you must reset its filter counter by pressing the corresponding button.



Fig 1



Fig 2



Fig 3

Remember to restock your filter cartridges from LPG Systems Customer Service so that you always have a spare.

INSTRUCTIONS FOR CONNECTING/DISCONNECTING MOTORISED CARE HEADS



Locked

Unlocked

To connect the heads to the hose, proceed as follows:

Lock the hose (fig.1)

Position the hose so that the hose key fits into its housing (fig.2)

Push the hose until it «clicks».



Fig 1

Hose key



Fig 2

To disconnect the heads, proceed with the following procedure:

Unlock the connection by turning the locking ring (Fig.3)

Lift the locking ring (fig.4)

Then remove the hose gently by pulling on the white ring (Fig.5)

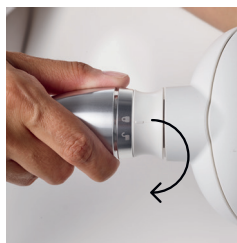

Fig 3



Fig 4



Fig 5

INSTRUCTIONS FOR ASSEMBLY AND DISMANTLING THE USB PROTECTIVE COVER

The USB protective cover can be dismantled in the case of device maintenance.

Disassemble and reassemble the access cover with the appropriate tool. The connector must not remain without a protective cover.



If your device's power cord is damaged, please contact your local distributor for replacement.

MAINTENANCE LOG SHEET

Replacement of the sealing valves: When the valves no longer allow proper care of the skin; they must be replaced. They must be replaced every 100 hours.

A SMALL PROBLEM! WHAT TO DO ?

In the event of abnormal operation of your device, before calling LPG Systems' Customer Service; it is advisable to carry out the following checks:

Is the device properly plugged into the AC outlet?

Is the AC outlet receiving power?

Is the power switch on?

Are the filter cartridges clean and in place?

Are the hoses connected correctly?

Is the treatment head connected correctly?

Once these checks have been carried out, if the malfunction persists, call LPG Systems' Customer Service or the authorised distributor closest to you, indicating the model of your device and its serial number.

LPG Systems Customer Service:

+33 (0)4 75 78 69 00

TECHNICAL SPECIFICATIONS

- > Dimensions LxIxh: 65x77x150 cm
- > Net weight: 68 kg
- > Regulated maximum vacuum: 69 kPa (690 mbar)
- > Cooling: by mechanical ventilation integrated into the pump
- > Ingress protection: IP 20
- > Electrical protection class: 1
- > Wifi: 5Ghz b/g/n
- > Electrical features:

REFERENCE OF THE DEVICE :	ELECTRICAL FEATURE :
CELLU M6 INFINITY®	220-240V 50Hz 730W 220-230V 60Hz 730W
CELLU M6 INFINITY®_OTW	100-127V 50/60Hz 730W
CELLU M INFINITY_KR	220V 50/60Hz 730W

- > Radiated power:
Channel b: 12.46dBm
G-channel: 9.33dBm
Channel n: 9.48dBm
BT 3.25dBm

Environmental characteristics of use:

- > Ambient temperature: + 10 to + 30°C in normal operation.
- > Ambient relative humidity: 30 to 75% non-condensing.
- > Atmospheric pressure: 800 to 1050 hPa (For use in a normally ventilated room)
- > Max altitude: 2500m

Environmental characteristics of transport and storage:

- > Temperature: -10°C to +70°C
- > Ambient relative humidity: 10 to 90% non-condensing
- > Air pressure: 800 to 1050 hPa

The CELLU M6 INFINITY® device is marked **CE** in accordance with the applicable standards and texts within the framework of the EMC 2014/30/EC and Low Voltage 2014/35/EC directives

**INDEX**

INFINITY 80 IW™ CARE HEAD DESCRIPTION

TR-30 IW™ HEAD DESCRIPTION

ADAPTER DESCRIPTION

ERGOLIFT IW™ HEAD DESCRIPTION

MAINTENANCE

INFINITY 80 IW™ CARE HEAD DESCRIPTION

The INFINITY 80 IW™ care head is designed for endermologie® body treatment.



MOTORISED FLAP/ROLL AND ROLL POSITION ADJUSTMENT

The INFINITY 80 IW™ care head has a 2-position adjustable stop that allows the spacing of the motorised flap/roll and the motorised roll to be adjusted, depending on the areas being treated.



Minimal spacing position



Maximal spacing position

To change the position of the cursor, move it to the desired position (to the right or left).

TR-30 IW™ CARE HEAD DESCRIPTION

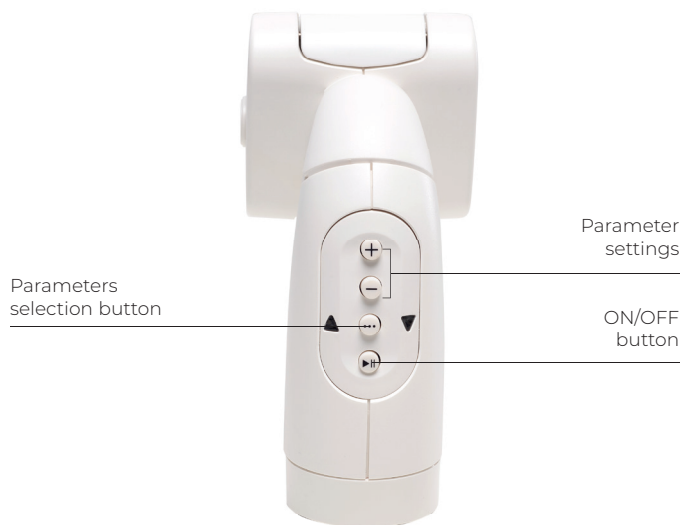

ERGOLIFT IW™ CARE HEAD DESCRIPTION



Ergolift chamber connection

ERGOLIFT IW™ CHAMBERS DESCRIPTION

The Ergolift® Lift 20 chamber is intended for the care of large areas of fine tissue and sensitive areas

The Ergolift® Lift 10 chamber is intended for the care of narrow areas, eye and lip contours, hands and fingers



> LIFT 10:

For tight areas, eyes and lip contour, hands and fingers.



> LIFT 20:

For large areas with fine tissues, and sensible areas.



Only the Lift 20 and Lift 10 chambers can be connected to the ergolift IW™ head.

They can be connected and disconnected by a simple push/pull action.

MAINTENANCE

The care heads are intended for use on healthy skin only.

For hygiene reasons, the cleaning of the care heads should be carried out before and after each use, heads disconnected from the device, using wipes impregnated with a bactericidal and fungicidal solution. Particular attention must be given to the cleanliness of the parts in contact with the customer.

1. INFINITY 80 IW™ CARE HEAD:

1. Remove the flap/roll modules as shown in the photos below (fig 1 to 4).
2. Clean meticulously for at least 1 minute using wipes impregnated with a bactericidal and fungicidal solution:
 - a. The embellisher flaps and their location (fig 5)
 - b. On either side of the rolls (rotate the rolls manually to access the entire surface) (fig.6)
 - c. The roller flap (fig. 7)
 - d. The head (fig.8)
3. Reassemble the flap/roll modules
4. Store the head in the storage drawer previously cleaned with wipes impregnated with a bactericidal and fungicidal solution



fig. 1



fig. 2



fig. 3

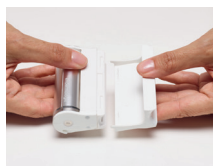

fig. 4



fig. 5



fig. 6



fig. 7



fig. 8

WARNING

Proscribe aggressive products such as acetone, trichlorethylene or alcohol at 90°.

2. TR-30 IW™ CARE HEAD

1. Remove the embellisher flap as shown in the photos below (fig 1). Repeat the operation on the 2nd flap .
2. Clean meticulously for at least 1 minute using wipes impregnated with a bactericidal and fungicidal solution:
 - a. The flaps and their location (fig 2 and 3)
 - b. On either side of the rolls (turn the head over, rotate the rolls manually to access the entire surface) (fig.4)
 - c. The hoof
3. Reassemble the embellisher flaps
4. Store the head in the storage drawer previously cleaned with wipes impregnated with a bactericidal and fungicidal solution



fig. 1



fig. 2



fig. 3



fig. 4

3. ERGOLIFT IW™ CARE HEAD

For reasons of hygiene, the maintenance of the care heads should be performed after each use, using antiseptic wipes impregnated with a bactericidal and fungicidal solution. Special attention must be given to the cleanliness of the parts that are in contact with the client.

1. Disconnect the chamber from the Ergolift treatment head. (fig. 1).
2. Remove the flap thanks to the dedicated tool. (fig. 2).
3. Thoroughly rub the Ergolift chamber, the flap and the tool for at least one minute with the wipes as describe here below. (fig. 3).
4. Put the flap back in the Ergolift chamber by following the same steps in reverseorder (fig. 4).



fig. 1



Removal tools



fig. 2



Rotation 90°



fig. 3



fig. 4



Rotation 90°

The Endermowear® care suit, available in several sizes for men and women, is a garment specially designed for body treatment performed with professional LPG® devices.

It is intended for personal use and its opaque areas protect the client/patient's private parts during the treatment. The unique composition of the Endermowear® suit guarantees excellent adhesion to the skin to facilitate the movements of the treatment head.

The products are delivered in a kit that the customer can personalise by indicating his name on the label provided for this purpose. It thus becomes the property of the customer and can be used for several sessions. For hygiene and aesthetic reasons, it is recommended to wash it after each use. To do this, refer to the washing instructions on the label of the treatment suit.

GENERAL WARRANTY CONDITIONS

You have just acquired a device distributed by LPG Systems, an LPG® subsidiary or an authorised LPG Systems distributor.

- It is the responsibility of the purchaser/user to inquire with the local authorities about the conditions and professional qualifications required to use this appliance. The acquisition of this device implies the automatic acceptance by the purchaser/user of these general warranty conditions.
 - In the event that the device is sold by an authorised LPG Systems distributor, the purchaser shall refer to the general warranty conditions of its supplier, which shall in no way have the effect of increasing the commitment made by LPG Systems under this warranty.
 - This warranty cannot be implemented and is only valid if the duly completed warranty flap has been returned to LPG Systems within 15 days of delivery for any country. Any warranty component that is not completely completed will not be processed.
 - This appliance is warranted against any defect in construction or defect in raw materials. The warranty period is equal to the shorter of two (2) years OR one thousand (1,000) hours of use from the date of invoice. During this period, we undertake to exchange or repair free of charge, as soon as possible, any part that we find to be defective, without however requiring a complete exchange of the device. Travel and accommodation costs for technicians as well as possible transport costs for the transport of the device and/or spare parts to the after-sales service workshop are excluded from this warranty.
 - Exchanges and repairs under the warranty, whether or not the device is immobilised, may not have the effect of extending the duration of the device. Replaced parts become the property of LPG Systems or the authorised distributor. No compensation may be awarded for loss of use.
 - For the exercise of the warranty, the purchaser/user must allow LPG Systems to carry out the necessary repair interventions
-

THE WARRANTY IS ALSO EXCLUDED IN THE EVENT OF:

- Damage that occurred during transport. The device and/or spare parts are transported at the risk and Perils of the addressee. It is the responsibility of the latter before taking delivery of the goods, to check its condition and, if necessary, to make complaints to the carrier in accordance with the forms and deadlines in force in the country of delivery.
- Failure to comply with the rules of installation and use, lack of maintenance and/or negligence in the maintenance of the device and/or filter cartridges, connection to a defective power line or one that does not have a connection to the earthing connection or a voltage other than that indicated on the device.
- Modification, mounting of accessories or dismantling of the device
- Any use and/or intervention not provided for in this LPG Systems user guide and carried out on the device by the purchaser/user and/or a third party not approved by LPG Systems.
- Use of consumables, spare parts, inappropriate components or parts not supplied by LPG Systems
- Blocking of the apparatus by the suction of a foreign body
- Normal wear and tear of one or more parts of the appliance resulting from normal use
- Damage or defects resulting from any accidental event (shock, fall, etc.). Damage due to natural disasters (lightning, water damage, etc.), fire, neglect or abuse.
-

If an appliance is to be resold before the end of the warranty, it will be transferred for the remaining period to the new purchaser provided that:

I- That the original invoice be communicated to him.

II- That the initial seller is informed of the transfer.

-
- Under this warranty, LPG Systems is only obligated to replace device components that meet the terms of this warranty. LPG Systems is not responsible for any loss or damage related to the product and/or its use, including financial loss, loss of profits, loss of use, etc.
 - This applies to loss and damage in any legal context.
 - Where the regulations in force prohibit or limit these exclusions of liability, LPG Systems excludes or limits its liability only to the price paid by the purchaser for the device and/or the service provided.

LIMITATION AND DISCLAIMER OF LIABILITY

- Failure to comply with the general warranty conditions during the warranty period and after the expiry of the warranty period may constitute an exoneration of LPG Systems' liability in the event of damage attributable to the products delivered.
 - The purchaser/user is responsible for the use of the device and will therefore assume full responsibility for any damage, and in particular damage caused to third parties, resulting from failure to comply with the instructions for use of the device and/or resulting from misuse
 - Under no circumstances will LPG SYSTEMS be required to compensate for immaterial or indirect damages, in particular any commercial or financial loss, loss of profit, loss of profit or damage to the brand image
 - LPG SYSTEMS' liability for all causes (with the exception of bodily injury) is limited to the amount of the price of the defective device.
 - The user is solely responsible for his prescriptions, care and advice given to his customers. The care and provision of care by the user or within his or her structure rests solely with the user and is left to his or her free discretion.
 - Consequently, LPG SYSTEMS cannot be held responsible in the event of inappropriate use of the device, any prescription, protocol and/or inappropriate care, any contraindication not respected.
-

SIÈGE SOCIAL LPG SYSTEMS

Technoparc de la Plaine
30, rue du Dr. Abel - CS 90035
26902 Valence Cedex 09 - France
TEL.: +33 (0)4 75 78 69 00
FAX: +33 (0)4 75 42 80 85

INTERNATIONAL/MARKETING

Ecolucioles - BAT A
255 Route des Lucioles - BP 243
06905 Sophia Antipolis - France
TEL.: +33 (0)4 92 38 39 00
FAX: +33 (0)4 92 96 09 65

