



Registered trademark

## OPERATOR'S MANUAL

# CELLU M6® Alliance Medical

**Please read the complete manual carefully  
before using your equipment.**

© Copyright 2024. LPG, CELLU M6 and Alliance are registered trademarks of LPG.  
Reproduction, even in part, is strictly prohibited.

GU 1601 - Kr  
Edition A1 - 01/24



Congratulations on the purchase of your CELLU M6® Alliance Medical. This model represents the fruits of numerous years of experience in the design and production of cutaneous tissue treatment systems. You will experience fully the technical perfection and reliability of LPG Systems, which is the leader in this sector. With the aim to continuously provide satisfaction, your device is equipped with a specific software devised to ensure connection with the LPG dedicated server. The data collected through this software will allow LPG to give you better services in respect of support and maintenance.

This operator's manual contains the operating description, basic maintenance instructions to be performed periodically and the safety instructions.

Your device is intended for use in the treatment of connective tissue. It should be used only by a professional who has attended the manufacturer's training provided by LPG Systems or an approved provider, if you live outside of France.

If you have any doubts whatsoever concerning the operation or maintenance of your equipment, please do not hesitate to contact LPG via the Customer Service Department of your distributor.

**+33 (0)4 75 78 69 00**

### ATTENTION

In order to respond better to customer requirements and expectations, LPG Systems is continuously researching ways of improving the design and quality of its products. This will explain the few minor differences between your equipment and the item described in this guide.

## → PACKAGE CONTENTS

- One CELLU M6® Alliance Medical device
- One Alliance 80 head
- One Alliance 50 head
- One TR30 head
- One set of micro-nozzles and micro-heads
- One Ergolift® head
- Two Ergolift® chamber (Lift20 and Lift10)
- One electrical power cord
- One unpacking instructions and quick installation guide
- One marketing set

### Liste of accessories provided with your device :

Depending on the version you have, (see serial number on the nameplate), some protocols are not activated and their accessories are not provided. Accordingly, the paragraphs describing them do not concern this version (see table below).

In any doubt about the operation of your unit or to evolve into a complete model, please contact the Customer Service of LPG Systems or your distributor.

	Pack body	Pack face	Pack therapeutic	Pack aesthetical medicine	Pack spa
Alliance 80	√				
Alliance 50			√	√	√
TR30			√	√	√
Micro-nozzles et micro-heads			√	√	
Ergolift		√		√	√
Ergolift chamber (Lift 10, Lift 20)		√		√	√
Unpacking instructions and quick installation guide	√	√	√	√	√
Cord	√	√	√	√	√
Marketing set	√	√	√	√	√

## → SOMMAIRE

1. DESCRIPTION OF THE DEVICE . . . . .	5
2. DESCRIPTION OF THE CONTROLS . . . . .	7
3. PRECAUTION FOR USE . . . . .	10
4. MAINTENANCE . . . . .	14
5. TROUBLESHOOTING . . . . .	22
6. TECHNICAL SPECIFICATIONS . . . . .	23
7. TREATMENT HEADS . . . . .	24
8. ENDERMOWEAR . . . . .	39
9. GENERAL WARRANTY CONDITIONS . . . . .	40
10. APPENDIX: ELECTROMAGNETIC COMPATIBILITY . . . . .	44

## → DESCRIPTION OF THE DEVICE

**INTENDED USE**

The CELU M6® Alliance Medical device is intended for therapeutic use. It can be used to :

1. Reduce secondary lymphedema of the arm after a mastectomy
2. Improve secondary lymphedema
3. Improve lymphatic circulation in the treated area
4. Relief of minor muscle aches and pains
5. Relieve muscle spasms
6. Temporary improvement in local blood circulation
7. Temporary relief of the minor muscular pain associated with DOMS (Delayed Onset Muscle Soreness)
8. Improves local circulation during burn rehabilitation
9. Reduce the appearance of cellulite and the circumference of treated areas
10. Temporarily improve lymphatic circulation and local blood circulation to improve skin trophicity in the treated areas
11. Improvement of skin quality, scars, fibrosis
12. Improvement of skin aging (wrinkles, fine lines, skin sagging, fat infiltration, firmness, elasticity, complexion, eye bags)
13. Stimulation of fibroblasts (collagen, elastin, hyaluronic acid synthesis)

The machine can be used in hospitals and rehabilitation clinics by specialists and physical therapists. It can be used on patients of any age, any weight, any sex. It is an independent device that cannot be combined with other machines. It should only be used by professionals who have been specially trained by LPG Systems how to use it and is not suitable for use at home.

**OPERATING PRINCIPES :**

The operating principles of the medical device CELLU M6® Alliance Medical consist of a suction force coupled with movements of rolls / valves, performed with treatment heads. These heads are placed on the healthy skin of the patient and then moved across the area to be treated by the professional who has been trained by LPG Systems.

 **ATTENTION**

The manufacturer reserves the right to amend the product technical specifications without prior notice. Any reproduction – even in part – is prohibited. All the illustrations in this operator's manual are non-binding.

## → THE CELLU M6® ALLIANCE MEDICAL DEVICE

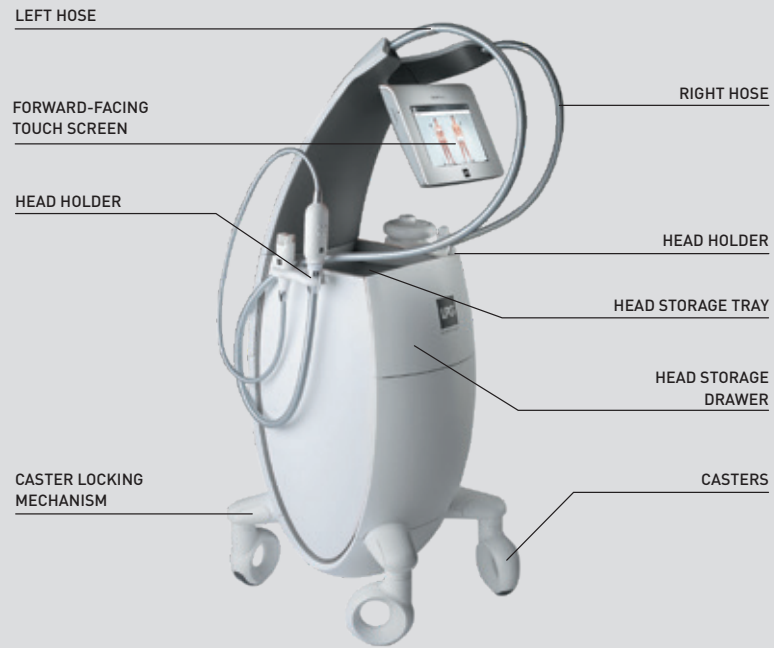

Before use, ensure that the power cord is completely unwound.



## → ACCES TO FILTER



RIGHT HOSE FILTER  
LEFT HOSE FILTER

### ACCES TO FILTERS

The filters are accessible via the back of the unit.

## → CONTROL SCREEN

### POWER INDICATOR

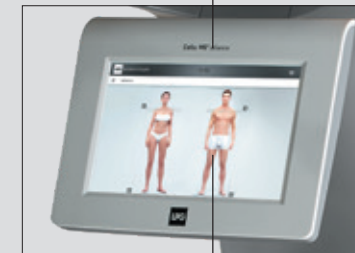

### TOUCH SCREEN

### ACCES USB PORT



### ⚠ ATTENTION

For detailed instructions on using the touch interface, refer to the touch interface operating manual received during training and available from customer service.

### ⚠ ATTENTION

The unit can only operate if it is connected to the mains by its power cord and provided the ON switch has been actuated and the green voltage light is on. After switching on the unit, please wait a few seconds for the screen to display information.

## → ALLIANCE 80 HEAD



## → ALLIANCE 50 AND TR30 HEADS

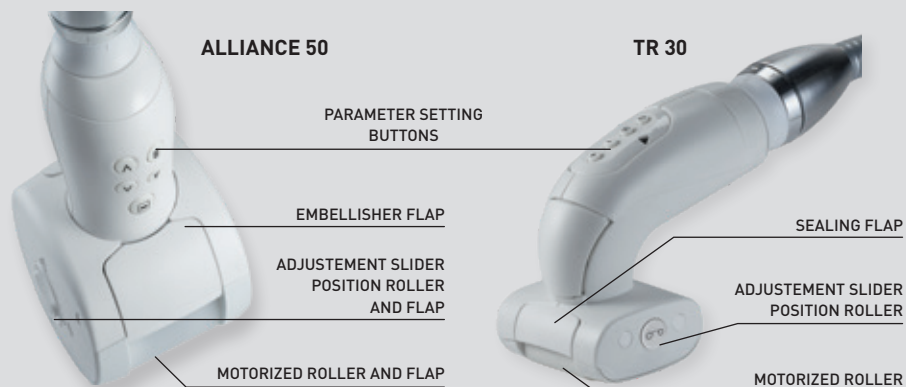

## → ADAPTATER ERGOLIFT HEAD

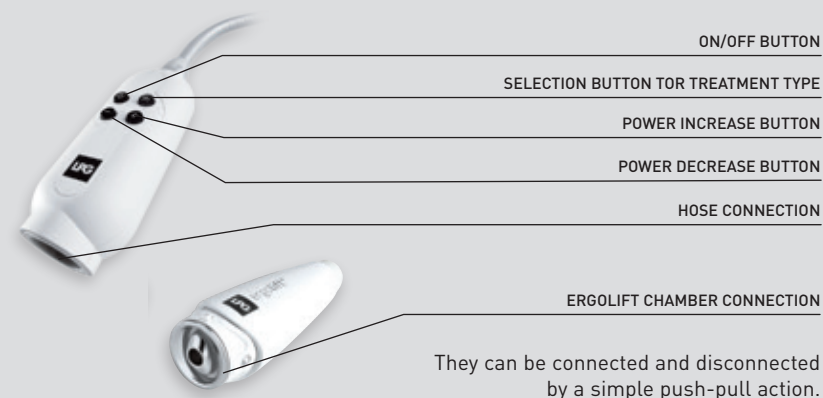

## → CASTERS

The CELLU M6® Alliance Medical is equipped with locking casters. Please follow the procedure indicated below to lock or unlock the casters :



### ⚠ ATTENTION

In cases where the unit has not been moved for a long time, it is possible that marks may form on the ground where the casters are. This phenomenon is the result of a chemical reaction between the components of some floorings and those of the wheels of the CELLU M6® Alliance.

## → IMPORTANT SAFETY INFORMATION

All safety precautions must be observed whilst using electrical equipment. Please read all safety notices and precautions prior to use of the equipment.

### **DANGER - TO MINIMISE THE RISK OF ELECTRICAL SHOCK:**

- Always disconnect the equipment from the electrical supply outlet after use and before cleaning and maintenance.
- Check that the supply voltage of the unit indicated on the data plate complies with the mains voltage.
- The unit must be connected by the power cord1 supplied to a grounded outlet in accordance with current electrical standards. Electrical adapters must not be used with this equipment.
- Ensure that the unit is connected to a system with a differential protection against DC and AC.

## → WARNING

- **TO MINIMISE THE RISK OF BURNS, FIRE, ELECTRICAL SHOCK OR INJURY:**
- The equipment must not be left unattended whilst connected to the electrical supply.
- Disconnect the unit from the electrical supply if it is not going to be used for a long period.
- Special attention is required whilst using the equipment with, or in the proximity of children or disabled persons.
- Never use the unit for purposes other than those recommended by LPG Systems. Only use the treatment heads supplied with your unit or recommended by LPG.
- Never use the equipment if:
  - The electrical power cord or outlet is damaged. The equipment does not function correctly. The equipment is damaged or has fallen or been dropped. The equipment has been exposed to excessive humidity.
- Do not move the unit by pulling the electrical power cord.
- Fully unwind the electrical power cord and keep it away from warm surfaces.
- Never use the equipment if the ventilation ports are obstructed. Ensure that the ventilation ports are kept clear of dust or other contaminants.
- Do not allow solid debris, liquid or other foreign bodies to fall or be sucked into the unit, as these could cause damage.

## → IMPORTANT SAFETY INFORMATION

- Never use the equipment on a dusty, uneven floor, or in a moist atmosphere.
- Never use the equipment in the presence of aerosols or oxygen.
- Before disconnecting the unit from the electrical supply, set all controls to the 'off' position and unplug the unit. The disconnection of the unit is disconnecting the power outlet.
- It is prohibited to modify this equipment without prior authorisation from the manufacturer.
- It is prohibited to use components or spare parts non recommended by LPG.
- Return the device to LPG Systems Service Center for examination and repair.

## → PRECAUTIONS FOR USE

### **ATTENTION: KEEP THESE INSTRUCTIONS.**

Your device should be used on healthy skin. It is important to read and respect the following precautions and contraindications before using your device.

- Never touch the patient and the device's unprotected cables or connectors simultaneously.
- Never use the adapter as a treatment head or allow it to come into direct contact with the skin.
- Only use treatment heads supplied with your unit or recommended by LPG.
- Do not use the treatment heads directly on the skin. Wear the treatment suit provided by LPG Systems, ENDERMOWEAR.
- LPG Systems will not be liable for any inappropriate use of the equipment.
- Improper use of the device can cause tissue damage or pain.
- The operator must be particularly attentive to the sensations felt by the person undergoing treatment.
- The operator must ensure that the parameters (intensity, sequentiality, differential...) are always adapted to the tissue being treated.
- Do not lean, rest, or sit on the unit.
- When crossing a threshold or step, we recommend moving the unit carefully by firmly holding the central arm monitor stand to avoid the risk of tipping.
- Do not use the USB connection during treatment.
- Do not operate the unit in unsuitable environmental conditions (see technical specifications).
- The power plug is used as disconnect device. The disconnection of the unit is disconnecting the power plug.
- Please position your device so that the mains unit is always accessible.
- Do not touch the patient and the hose connectors simultaneously
- Do not use the treatment heads in contact with vegetable oils

### **ATTENTION**

Europe VII-H05VVF3G1,50-C19; Italy I/3/16-H05VVF3G1,50-C19; Switzerland 23G-H05VVF3G1,50-C19; UK BS13/13-H05VVF3G1,50-C19; Japan 498GJ-VCTF3X2,00-C19; USA, Canada, Mexico N5/15-SJT3X14AWG-C19 (connect to Hospital grade receptacle in hospital environment).

## → CONTRA-INDICATIONS

- Do not treat open wounds, the eyes, intra-cavity areas, mucous membranes, the genitals or breasts.
- This device is not recommended for pregnant women. In the event of pregnancy, do not treat the lumbar-abdominal region. Consult with a doctor with regard to this treatment.
- Do not treat a patient with an infectious disease, a growing tumour, a phlebitis, a wound, or an infected area.
- Do not treat a patient with skin cancer, a visible tumor, or other cancerous lesions. Consult with a doctor in cases where the patient has a case history of tumours or is in remission.
- Do not treat inflammatory areas or scars without medical advice and LPG technical training for the affected areas.
- Do not treat people with circulatory problems without first consulting their doctor and without training in LPG technology for the affected areas.
- Do not treat a patient with an unexplained and persistent pain without medical advice and without training in LPG technology for the affected areas.
- Do not treat a patient after an invasive medical treatment without medical advice or surgeon who carried out the treatment and without training in LPG technology for the affected areas.
- To avoid bruising, exercise caution when determining a patient's level of sensitivity and avoid use on patients taking anticoagulant drugs.
- Stop treatment immediately if the patient experiences pain and consult a doctor.
- This device should not be used on all dermatoses, skin rashes, herpes, inflammatory or infectious acne or vitiligo.
- Because of the risk of interference, it is important that the professional ensures the patient is not equipped with a personal medical device such as a pacemaker. If this is the case, the professional should obtain details about the device in question to ensure that any interference will not affect the correct use of the equipment.
- As this list is not exhaustive, always seek out medical advice in the event of doubt.
- For a more detailed list of indications and against indications, refer to training manuals.

## → ELECTROMAGNETIC COMPATIBILITY

- Your CELLU M6® Alliance Medical device requires special care concerning the EMC, it must be installed and service according to the information provided in this user guide.
- Portable and mobile RF communication devices must not be used near your device, they can cause undesired operation.
- The use of other treatment heads than those provided by LPG may result in increased emissions or decreased immunity of the device.
- Your CELLU M6® Alliance Medical device should not be used adjacent to or stacked with other medical devices.
- Interference may occur near equipment marked with the following symbol:



For more information concerning the electromagnetic compatibility, refer to appendix « Electromagnetic compatibility »

### ⚠ ATTENTION

This unit contains programs to help the operator obtain the best anticipated results for each case undergoing treatment. Under no circumstances may these programs be construed as a guarantee of successful treatment, which varies, depending on the morphology, physiology and eating behavior of each patient.

## → IDENTIFICATION RATING PLATE

Your unit is identified by a serial number shown on the rating plate. The rating plate also shows the permitted supply voltage for the unit. If you need to contact LPG Systems because of a technical problem, please indicate the serial number of your CELLU M6® Alliance Medical. This serial number provides information on the year and month of manufacture of your unit.

The letter indicates the year the device was manufactured. Z=2009, A=2010, B=2011, etc.

The two digits indicate the production month: 01=January; 02=February; 03=March; etc.

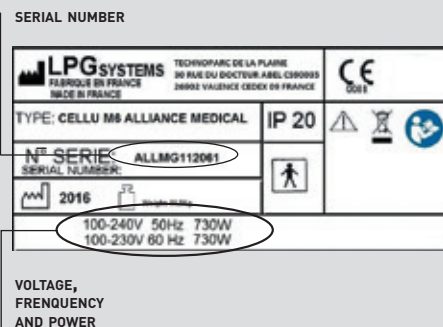

This icon indicates that the unit was sold after August 13, 2006. In conformity with the 2002/96/CE directive, it cannot be thrown away with standard household waste but must be disposed of by means of recycling. When your device reaches the end of its useful life, it must be brought to an appropriate recycling center or returned to your dealer. By doing so, you help the environment by contributing to the conservation of natural resources and the protection of human health.



This icon indicates that some specific warnings or precautions associated with this device are not on the label.



This symbol means you must consult the accompanying documents before using your device.



This symbol indicates the name and address of the manufacturer.



This symbol means that your device has type BF applied parts which come into contact with the patient. These parts are electrically isolated from all of the device's other parts. These applied parts are: the treatment heads.



This symbol means store the device somewhere protected from inclement weather.



This symbol indicates temperature limits.



This symbol indicates the weight of the device



This symbol indicates relative humidity limits.



This symbol means « Do not push »



This symbol means « danger: High Voltage »



This symbol means « use under prescription » (US only).



This symbol indicates the year of the manufacturing



This symbol indicates fragile, handle with care



This symbol indicates keep it vertical



This symbol indicates not reverse



This symbol indicates atmospheric pressure limits.

## → CLEANING THE UNIT

It is recommended that you clean your unit as often as possible, not only for reasons of hygiene and aesthetics but also because cleaning the unit will help keep it in a good state of repair and extend its useful life.

**Using a vacuum cleaner with a fine nozzle, clean the following sections:**

- Interior of the head storage drawer.
- Interior of the head storage tray.
- Interior of the filter access door.

**Using a moist sponge, clean the following sections:**

- All the external hoods.
- Hoses.
- The electrical power cord.

**Using a cloth soaked with a small amount of alcohol-free domestic cleaning product, clean the following sections:**

- Control screen and control panel.
- Interior of the head storage drawer.
- Interior of the head storage tray.
- Interior of the filter access door.

**Using an antistatic cloth soaked or wipes, clean:**

- The touch screen.

The maintenance of the treatment heads should be performed before the first use, see chapter «treatment heads».

## ⚠ ATTENTION

The identification rating plate is located on the underside, at the back of the unit. Identification rating plates may vary. The approved one is one on your machine.

## ⚠ ATTENTION

Proscribe aggressive products such as acetone, trichlorethylene or alcohol at 90°.

## → REPLACING THE FILTER CARTRIDGES AND FOAM

Your device contains two filter cartridges and one filter foam.  
These components guarantee the efficiency of your unit and prolongs its useful life.

Ensure that they are changed as soon as the command screen displays one of these messages (**Fig 1-2**) :

Icon indicating a filter change is required (**Fig. 2**).

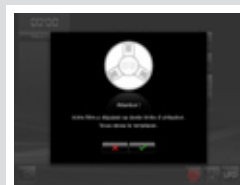

FIG. 1

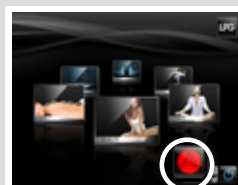

FIG. 2

CHANGE THE FILTERS

Access the 'filter change' menu as follows :

Select the 'maintenance' menu by pressing the icon indicated (**Fig. 3**).

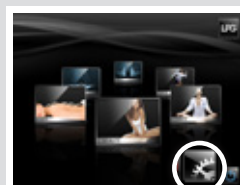

FIG. 3

PRESS THIS ICON

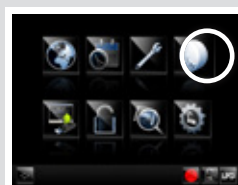

FIG. 4

PRESS THIS ICON

The 'filter change' screen indicates which filter requires changing (**Fig. 5**).

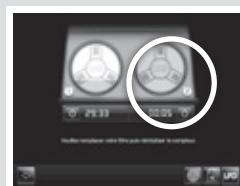

FIG. 5

FILTER TO CHANGE

## → REPLACING THE FILTER CARTRIDGES AND FOAM

Replace the filter cartridges as follows :

1. Open the filter access door.  
(**Fig 1**)

2-3. Unscrew and remove the filter cartridges and replace them with new ones. (**Fig 2 et Fig 3**)

4. Remove the filter foam and replace it with a new one.  
(**Fig 4 et Fig 5**)

Remember to purchase new filter cartridges from the LPG Systems Customer Service Department so you always have a spare.

5. Once the filter cartridge is replaced, the filter meter should be reset by pressing the icon indicated:  
(**Fig 6**)



FIG. 1



FIG. 2



FIG. 3

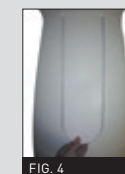

FIG. 4

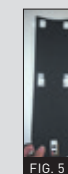

FIG. 5



FIG. 6

FILTER METER

### ATTENTION

The device must never be used without a filter. If no filter is fitted, the device must be switched off.

## → CONNECTING / DISCONNECTING THE MOTORIZED TREATMENT HEADS

To connect the heads to the hose, follow the procedure below.

Position the locking ring in the locked position **(Fig.1)**

Position the end of the hose so that the hose key is lined-up with the key slot of the treatment head connection **(Fig.2)**

Push the hose into the treatment head connection until it clicks into place.

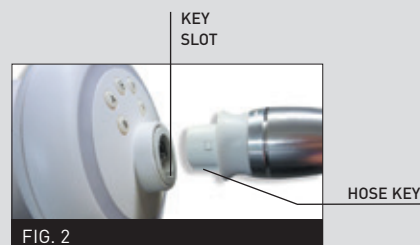
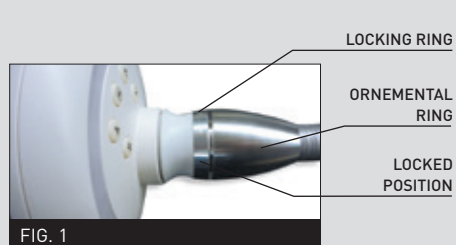
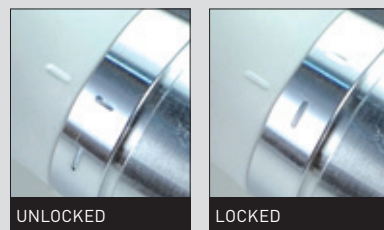

To disconnect the heads to the hose, follow the procedure below.

Position the locking ring in the unlocked position **(Fig.3)**

Pull the locking ring towards the hose **(Fig.4)**

Carefully remove the hose by pulling it by the white ring **(Fig.5)**

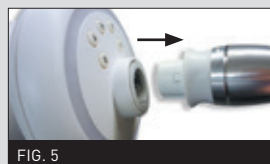
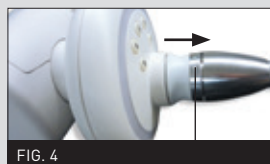

UNLOCKED  
POSITION

## → CONNECTING / DISCONNECTING THE ADAPTER

To connect or disconnect the hose adapter, follow the procedures described on the chapter 4.4 « Connecting / Disconnecting the motorized treatment heads ».

The connection is made with a simple push/pull movement.

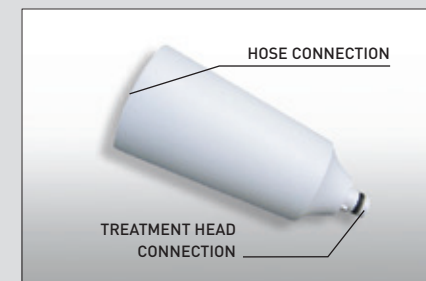

Only the micro-heads and the micro-nozzles can be connected to the adapter. The connexion is made with a simple push/pull movement.



## → INSTRUCTION TO REMOVE USB PROTECTIVE COVER



Remove the access cover to the USB port by using the appropriate tool.

## → REPLACING THE POWER CORD

If the power cord of your device is damaged, please contact LPG Systems Customer Service for a replacement.

LPG Systems Customer Service: +33(0)4 75 78 69 00

## → MAINTENANCE LOG SHEET

Replacement of filter cartridges: To be done when the warning message.  
Replacement of sealing flap: To be done when the flaps no longer treat the skin properly. They should be replaced after every 100 hours of use.

DATE	N° OF HOURS	OPERATION PERFORMED

## → WHAT IF I'VE A PROBLEM ?

**If your unit is not working properly, proceed with the following checks before calling Customer Services:**

- Is the unit properly connected to a mains plug?
- Is the mains plug live?
- Is the ON switch lit up?
- Are the filter cartridges clean and correctly placed?
- Are the hoses properly connected?
- Are the treatment heads properly connected ?
- Is the connected treatment head connected corresponds to that shown on the screen?

Once these checks have been carried out and if the malfunction persists, please contact Customer Services of LPG Systems or the nearest authorized dealer, indicating the model of your unit and its serial number.

**Service Client de LPG Systems :**  
**+33 (0)4 75 78 69 00**

## → TECHNICAL SPECIFICATIONS

Dimensions LxWxH: ..... 61x70x140 cm  
 Net weight: ..... 80,5 kg  
 Maximum set depression: ..... 69 kPa (690 mbar)  
 Cooling: ..... by mechanical ventilation incorporated in the pump  
 Protection index: ..... IP 20  
 Electrical protection class: ..... 1  
 Wifi: ..... 2,4Ghz b/g/n  
 Electrical features: ..... 100-240V 50Hz 730W  
 ..... 100-230V 60Hz 730W

Operating environmental features:

Ambient temperature: ..... + 10 à + 30°C for normal use.  
 Ambient relative humidity: ..... 30 à 75% without condensation.  
 Atmospheric pressure: ..... 800 à 1050 hPa (For use in a normally ventilated room)  
 Max altitude: ..... 2500m

Environmental characteristics of transport and storage:

Temperature: ..... -20°C to +70°C  
 Ambient relative humidity: ..... 10 to 90% without condensation  
 Atmospheric pressure : ..... 800 to 1050 hPa (For use in a normally ventilated room)

Your device is equipped with patented treatment heads (applied parts type of BF).

The CELLU M6® Alliance Medical device is marked  as a medical device by virtue of Annex II of regulation 93/42/EEC (applicable standards IEC 60601-1 Ed3 and related standards).

TREATMENT HEADS

CELLU M6® Alliance Medical



Registered trademark

DESCRIPTION OF ALLIANCE 80 HEAD .....	26
DESCRIPTION OF ALLIANCE 50 HEAD .....	28
DESCRIPTION OF TR30 HEAD .....	30
DESCRIPTION OF ERGOLIFT HEAD .....	31
DESCRIPTION OF MICRO-HEADS AND MICRO-NOZZLES .....	32
MAINTENANCE .....	33

## → DESCRIPTION OF THE ALLIANCE 80 HEAD

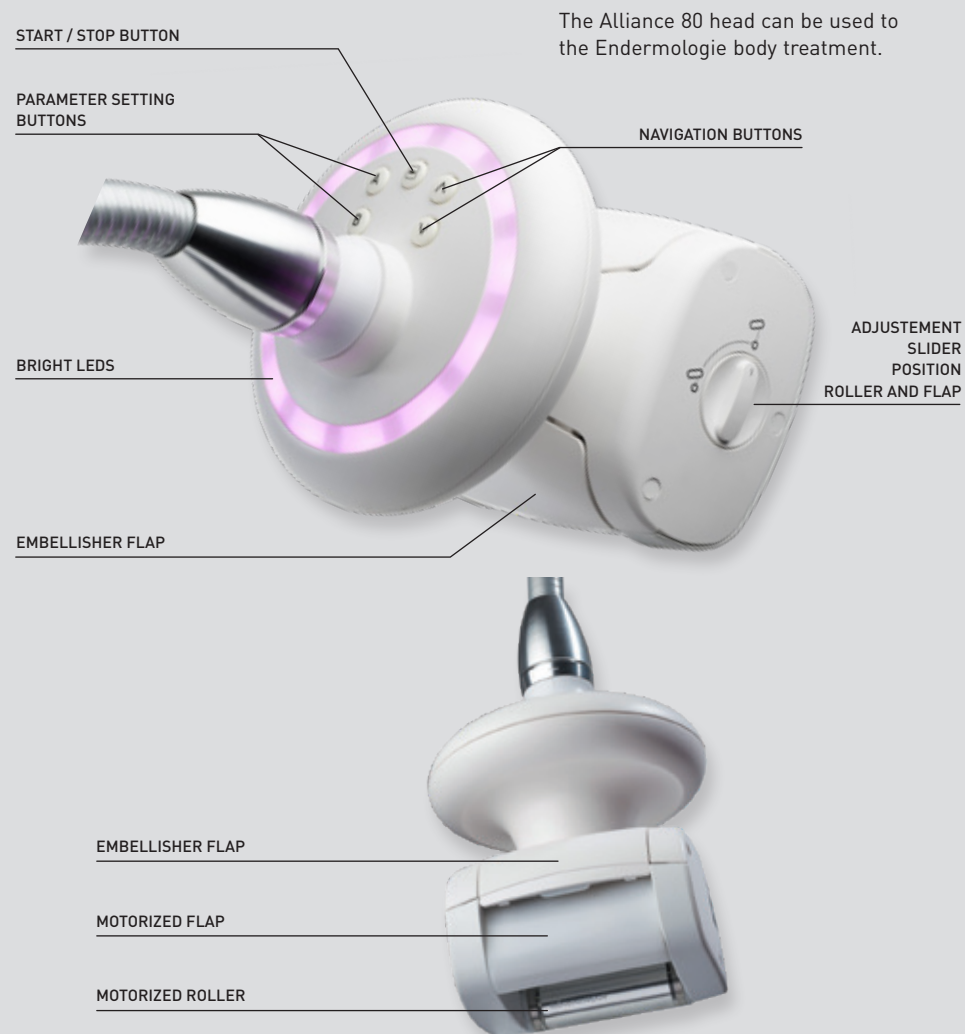

## → DESCRIPTION OF THE ALLIANCE 80 HEAD

## ADJUSTMENT OF ROLLER AND FLAP POSITION

Alliance head 80 has an adjustable stop with 2 positions for adjusting the distance between the motorized roller and of the damper.

When the cursor is in the horizontal position, the maximum mobility of the rollers is ensured.

When the cursor is in the vertical position, the minimum mobility of the rollers is ensured.

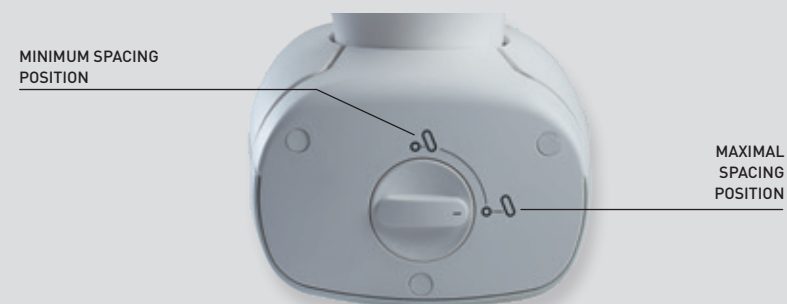

To change the adjustment slider turns it into the holding down to the desired position, as shown in the photo below:

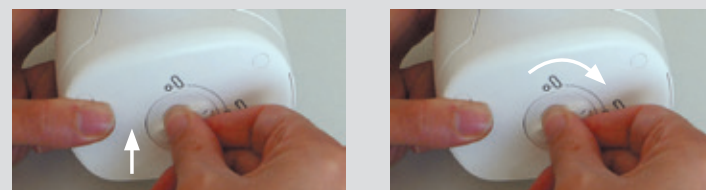

## → DESCRIPTION OF ALLIANCE 50 HEAD

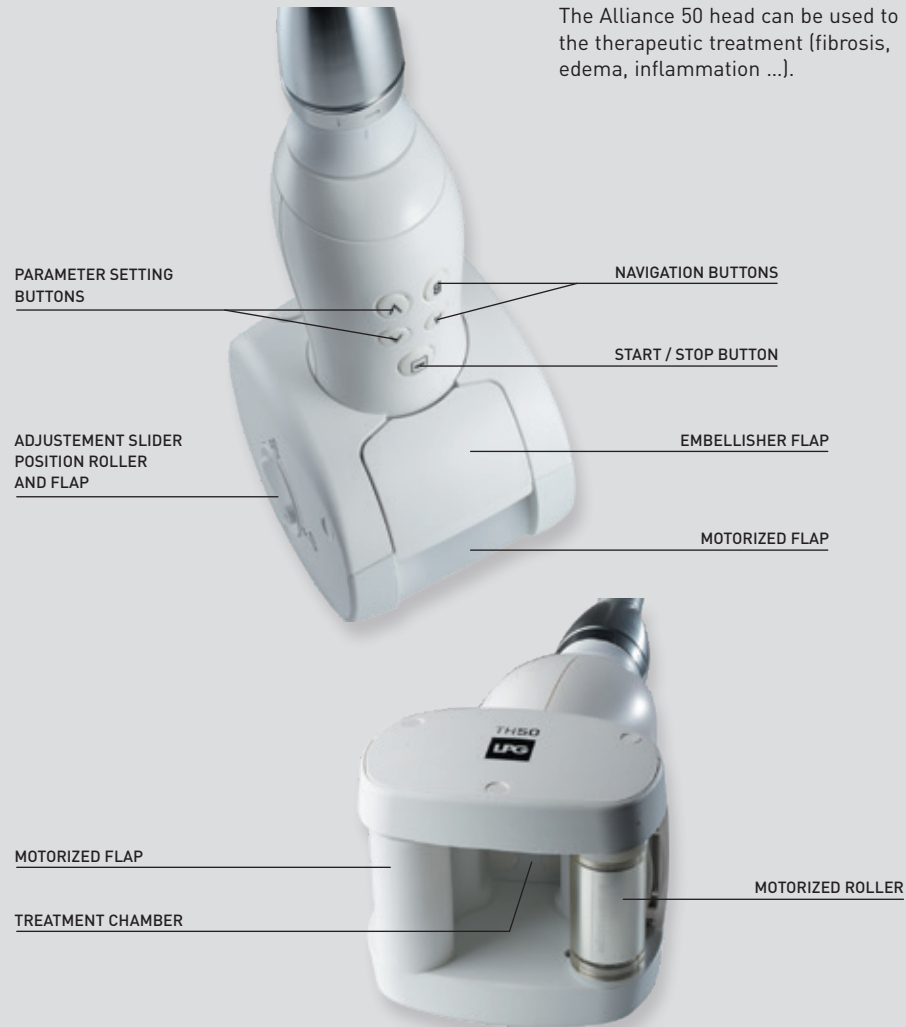

## → DESCRIPTION OF ALLIANCE 50 HEAD

### ADJUSTMENT OF ROLLER AND FLAP POSITION

Alliance head 80 has an adjustable stop with 2 positions for adjusting the distance between the motorized roller and of the damper.

When the cursor is in the horizontal position, the maximum mobility of the rollers is ensured.

When the cursor is in the vertical position, the minimum mobility of the rollers is ensured.

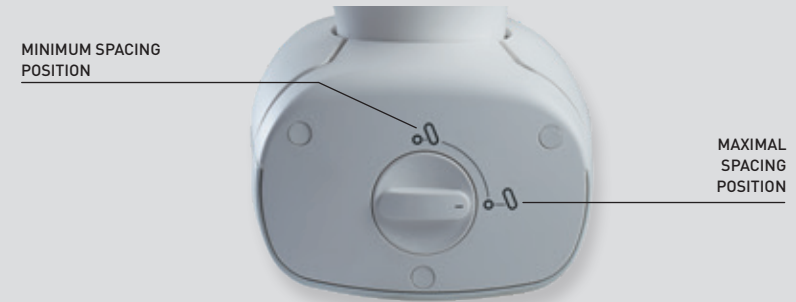

To change the adjustment slider turns it into the holding down to the desired position, as shown in the photo below:

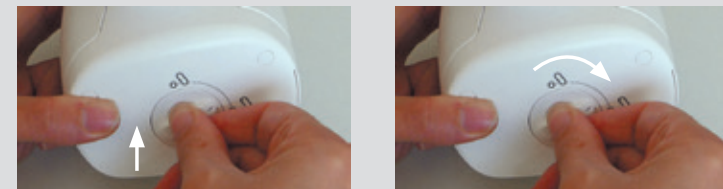

## → DESCRIPTION OF TR30 HEAD



## → DESCRIPTION OF THE ERGOLIFT HEAD

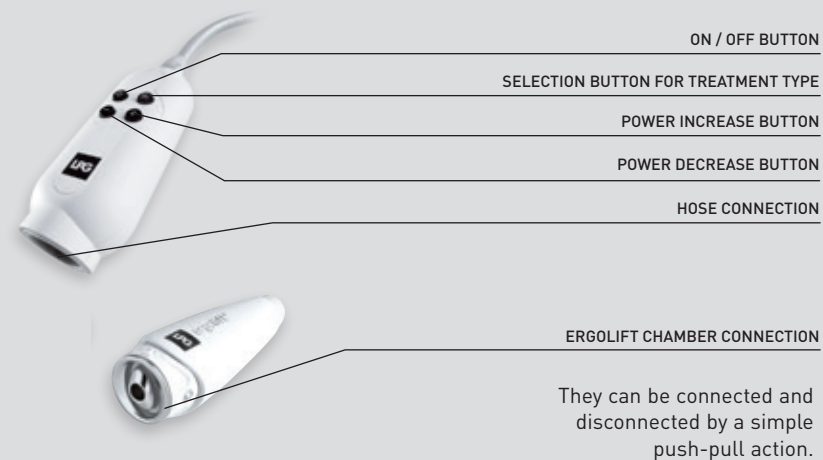

## → DESCRIPTION OF ERGOLIFT CHAMBERS

The Egolift chamber Lift 20 can be used to the treatment of large areas with fine tissues, and sensible areas. The Ergolift chamber Lift 10 can be used to the treatment to tight areas, eyes and lip contour, hands and figers.

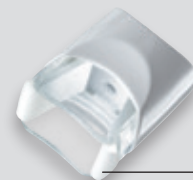

**Lift 20**  
Treatment chamber with removable flap

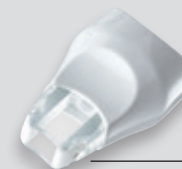

**Lift 10**  
Treatment chamber with removable flap

Only the LIFT 20 and LIFT 10 can be connected to the Ergolift head. They can be connected and disconnected by a simple push-pull action.



## → DESCRIPTION OF MICRO-HEADS AND MICRO-NOZZLES



## → MAINTENANCE

For reasons of hygiene, the maintenance of the treatment heads should be performed after each use, using antiseptic wipes impregnated with a bactericidal and fungicidal solution. Special attention must be given to the maintenance of the parts that are in contact with the patient.

**THE ALLIANCE 80 HEAD**

1. Remove the sealing flaps (2 up flaps and 1 down flap) as showed in the pictures below **(fig 1 à 4)**.
2. Thoroughly rub for at least one minute with the wipes as describe here below.:
  - a) Flaps and their housing **(fig 5 to 7)**.
  - b) The casing on both sides of the rollers (turn the head over, rotate the rollers manually to clean the entire surface) **(fig. 8)**.
  - c) The motorized flap (Don't mobilize the motorized flap) **(fig 9 & 10)**.
  - d) Le sabot
3. Reattach the sealing flaps
4. Maintain the storage drawer using LPG wipes, then place the head in it.



Fig 1



Fig 2



Fig 3



Fig 4



Fig 5



Fig 6



Fig 7



Fig 8

Fig 9



Fig 10

## → MAINTENANCE

## THE ALLIANCE 50 HEAD

1. Remove the sealing flaps (2 up flaps and 1 down flap) as showed in the pictures below (fig 1 to 4).
2. Thoroughly rub for at least one minute with the wipes as describe here below.:
  - a) Flaps and their housing (fig 5 to 7).
  - b) The casing on both sides of the rollers (turn the head over, rotate the rollers manually to clean the entire surface) (fig. 8)
  - c) The motorized flap (Don't mobilize the motorized flap) (fig 9 & 10).
  - d) Le sabot
3. Reattach the sealing flaps
4. Maintain the storage drawer using LPG wipes, then place the head in it.



Fig 1

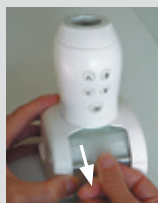

Fig 2

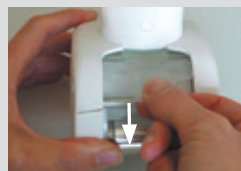

Fig 3



Fig 4



Fig 5



Fig 6



Fig 7



Fig 8



Fig 9



Fig 10

## → MAINTENANCE

## THE TR30 HEAD

1. Remove the sealing flaps as showed in the pictures below (fig 1).
2. Thoroughly rub for at least one minute with the wipes as describe here below:
  - a) The flaps and their housing (fig 2 & 3).
  - b) The casing on both sides of the rollers (turn the head over, rotate the rollers manually to clean the entire surface) (fig. 4)
  - c) Le sabot
3. Reattach the sealing flaps
4. Maintain the storage drawer using LPG wipes, then place the head in it.

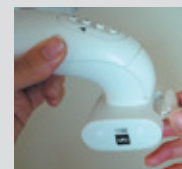

Fig 1

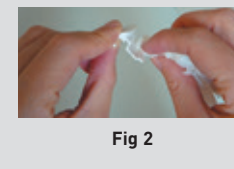

Fig 2

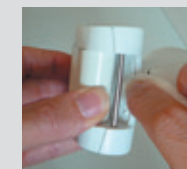

Fig 3

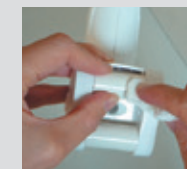

Fig 4

## ⚠ ATTENTION

Don't mobilize the motorized flap manually.

## → MAINTENANCE

**MICRO-HEADS AND MICRO-NOZZLES**

1. Disconnect the micro-heads or micro-nozzles from the adapter.
2. For the micro-heads, use the dedicated tool provided (**fig 1 & 2**).
3. Thoroughly rub for at least 1 minute the rollers, seal, treatment chamber, microheads disassembly tool, and micro-nozzles with LPG wipes soaked in a bactericide and fungicide solution (**fig. 3**).
4. Refit the rollers and check they spin freely.
5. To maintain the micro-heads use cotton soaked with the same solution.
6. Maintain the storage drawer using LPG wipes, then place the heads in it.



FIG. 1



FIG. 2



FIG. 3

## → MAINTENANCE

**DESINFECTING THE MICRO-HEADS AND MICRO-NOZZLES**

The motorized treatment heads (Alliance 80, Alliance 50 and TR30) need to be used with an Endermowear suit. Non-motorized treatment heads (micro-nozzles, and micro-heads) can be used directly on the skin in specific cases.

In these cases, the heads need to be disinfected after each use:

1. Use the maintenance procedure described above.
2. Soak the rollers, micro-heads, disassembly tool, and micro-nozzles in a disinfectant for 12 minutes at 20° C, as recommend on the disinfectant packaging.
3. Carefully rinse the flap and the treatment chamber with sterile or drinking water for at least 1 minute using a large volume of water (approximately 8 liters). Repeat twice for a total of 3 rinses.
4. Dry the parts.
5. Pre-clean the storage drawer using LPG wipes, then place the head in it.

## ⚠ ATTENTION

Use a disinfectant whose active ingredient is ortho-phthalaldehyde [OPA]. Before using the disinfectant, read and follow the recommendations, contraindications, and warnings associated with this product. Refer to the instructions for using this solution. All the procedures described in this section must be carried out with the machine turned off and the power cord unplugged. - Do not use corrosive products such as acetone, trichloroethylene, or rubbing alcohol, nor abrasive sponges.

## → MAINTENANCE

**ERGOLIFT HEAD AND ERGOLIFT CHAMBERS**

For reasons of hygiene, the maintenance of the treatment heads should be performed after each use, using antiseptic wipes impregnated with a bactericidal and fungicidal solution. Special attention must be given to the rub of the parts that are in contact with the patient.

1. Disconnect the chamber from the Ergolift treatment head. **(fig. 1)**
2. Remove the flap thanks to the dedicated tool. **(fig. 2)**
3. Thoroughly rub the Ergolift chamber, the flap and the tool for at least one minute with the wipes as describe here below. **(fig. 3)**
4. Put the flap back in the Ergolift chamber by following the same steps in the reverse order **(fig. 4)**



FIG. 1 REMOVAL TOOLS

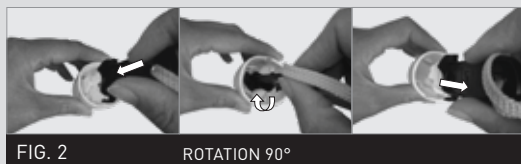

FIG. 2 ROTATION 90°



FIG. 3

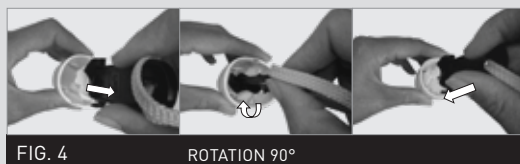

FIG. 4 ROTATION 90°

## → MAINTENANCE

**DESINFECTING OF ERGOLIFT CHAMBERS**

The Ergolift head is in direct contact with patient's skin. Under certain specific applications, it needs to be disinfected after each use:

1. Follow the maintenance procedure described above.
2. Soak the flap and Ergolift chamber in an OPA disinfectant for 12 minutes at 20° C, as recommended on the disinfectant packaging.
3. Carefully rinse the flap and the Ergolift chamber with sterile or drinking water for at least 1 minute using a large volume of water (approximately 8 liters). Repeat twice for a total of 3 rinses.
4. Dry the Ergolift chamber and flap.
5. Clean the storage drawer with antiseptic wipes, then place the Ergolift chamber and flap in it.

## → ENDERMOWEAR™

LPG Endermowear™ is available in several sizes for men and women and has been specially designed for body treatments. It is intended for personal use, guarantees hygiene, and its opaque areas cover the patient's intimate parts during the treatment. Endermowear™'s unique material guarantees excellent adhesion to the skin which facilitates movement of the treatment head.

The products are delivered in a bag that the customer can personalize by putting their name on the label. It becomes the customer's property and can be used for several sessions. For esthetic reasons and hygiene, it should be washed after each use. Please refer to the washing instructions indicated on the bag label.

## ⚠ ATTENTION

The use of aggressive products, such as acetone, trichloroethylene, or alcohol at 90°, and abrasive sponges, ultrasound or UV lamps is strictly prohibited. All cleaned and/or disinfected heads should be placed in the storage drawer to avoid any confusion. Use a disinfectant whose active ingredient is ortho-phthalaldehyde [OPA]. Before using the disinfectant, read and follow the recommendations, contraindications, and warnings associated with this product. Refer to the instructions for using this solution. All the procedures described in this section must be carried out with the machine turned off and the power cord unplugged.

## → GENERAL WARRANTY CONDITIONS

You have recently acquired an appliance distributed by LPG Systems or an LPG Systems approved distributor. It is the purchaser/user's responsibility to find out from the local authorities the conditions and professional qualifications required before using the appliance.

The purchase of this equipment implies the legal acceptance by the purchaser/professional user of these general warranty conditions. If the appliance was sold to you by an approved LPG Systems distributor, the purchaser/user should refer to the supplier's warranty conditions. These may in no way increase the undertakings made by LPG in these present warranty conditions.

The warranty can only be implemented and is only valid if the warranty slip has been duly filled out and returned to LPG Systems within two weeks of delivery, irrespective of the country. Warranty slips that are only partially completed will be rejected. The appliance is guaranteed against manufacturing flaws and defects in the raw materials.

The warranty extends for the shorter of the following two periods: one (1) year OR two thousand (2000) hours of use from the invoice date. During this period, LPG Systems undertakes to exchange or repair free of charge, as quickly as possible, any part that LPG Systems acknowledges as defective,

however LPG Systems does not undertake to replace the entire appliance.

Traveling and living expenses for our technicians and transportation costs of the appliance or parts to and from the aftersales service workshop are not covered by this warranty. Replacements and repairs performed within this warranty, with or without immobilization of the equipment, shall not have the effect of extending the warranty period.

Replaced parts become the property of LPG Systems or the approved distributor. No compensation shall be paid for loss of use. Subject to other conditions hereafter, warranty shall apply if the purchaser/professional user has allowed LPG to proceed to necessary repair works.

## → GENERAL WARRANTY CONDITIONS

**Warranty exclusion:**

- Damage occurring during transportation. Transportation of this equipment and/or spare parts is at the recipient's own risk. Before taking delivery, it is the recipient's responsibility to verify the state of the goods and to make a claim against the transport company in the manner usual in the delivery country.
- Non-observance of the installation and operating instructions, failure to carry out maintenance and/or negligence in maintaining the appliance and/or its filter cartridges, connection to a faulty electricity supply or a non-earthed electricity supply or a power supply whose voltage is different to the one indicated on the appliance.
- If an appliance is sold before the end of the warranty period, the warranty is transferred to the purchaser for the remaining warranty period, on the condition that:
  - I The original invoice is provided.
  - II That the initial vendor is informed of the sale.
- Modification, mounting of accessories or dismantling of the equipment.
- Any operation and/or intervention not specified in the LPG Systems Operating Instructions and performed on the equipment by the purchaser/user and/or any party not approved by LPG Systems.
- Use of consumables, spare parts, inappropriate components or parts not supplied by LPG Systems.
- Blockage of the appliance through aspiration of a foreign body.
- Normal wear and tear of any of the equipment's parts resulting from normal usage.
- Damages or default resulting of accidental events (falls, impacts...)  
Damages or default resulting of natural disasters (lightening, water damages...) Fire, negligence or abuses.

## → GENERAL WARRANTY CONDITIONS

The warranty is limited to the replacement of the components of the device which comply with conditions described above. Under no circumstances shall LPG be liable for any loss or damage as a result or in connection with the device and/or its use, including any financial loss, loss of margin, loss of use, etc. This clause shall apply under any and all legal basis. Whenever the above restriction may not be applicable or enforceable, LPG liability shall be limited to the price for the device and/or the service.

## → WARRANTY ACTIVATION

You can activate your warranty online by connecting to our warranty webpage:

<http://warranty.lpgsystems.com>

## → OR FILL IN THE FORM AND RETURN TO LPG SYSTEMS



Name\*: .....

Address\*: .....

Country\*: .....

Tel\*: .....

Email: .....

Type of business: .....

Profession: .....

Type of unit: **CELLU M6® ALLIANCE MEDICAL**

Serial number\*: .....

Date: .....

The personal data collected in this form are sent to LPG Systems, which is responsible for processing it in order to manage customers relations, including after-sales service and warranties. Information with an asterisk must be provided in order for this form to be processed. According to modified French law 78-17 from January 6, 1978 relating to computers, digital files, and freedoms, also known as the "Informatique et Libertés" law, you have a right of access, rectify, and remove personal data about you by contacting LPG Systems in writing at the following address: LPG SYSTEMS – 30, rue Dr Abel – Technoparc de la Plaine – 26000 VALENCE (FRANCE).

### ATTENTION

To validate the warranty, detach this slip and return to the address below within 15 days following use of the unit:

**LPG SYSTEMS® SA – Technoparc de la plaine-  
30, rue du docteur Abel – CS 90035 – 26902 VALENCE Cedex 9 – France**

## → APPENDIX: ELECTROMAGNETIC COMPATIBILITY

TABLE 1: DIRECTIVES AND MANUFACTURER DECLARATION – ELECTROMAGNETIC EMISSIONS

CELLU M6® ALLIANCE is intended for use in the electromagnetic environment specified below. The CELLU M6® ALLIANCE customer or patient should ensure that it is used in such an environment.

Emissions test	Conformity	Electromagnetic Environment - Directives
RF emissions CISPR 11	Group 1	CELLU M6® ALLIANCE uses RF energy only for its internal functions. Therefore, its RF emissions are very low and unlikely to cause interference in nearby electronic devices.
RF emissions CISPR 11	Class B	CELLU M6® ALLIANCE may be used in all establishments, including domestic sites and sites that are directly connected to the low voltage public power grid, which supplies domestic buildings.
Harmonic emissions IEC 61000-3-2	Class A	
Voltage fluctuations and flicker IEC 61000-3-3	Conforms	

TABLE 2: DIRECTIVES AND MANUFACTURER DECLARATION – ELECTROMAGNETIC IMMUNITY – EMISSIONS TESTS

CELLU M6® ALLIANCE is intended for use in the electromagnetic environment specified below. The CELLU M6® ALLIANCE customer or patient should ensure that it is used in such an environment.

Emissions test	Conformity	Conformity	Electromagnetic Environment - Directives
Electrostatic discharge (ESD) IEC 61000-4-2	± 6 kV on contact ± 8 kV in the air	± 6 kV on contact ± 8 kV in the air	Flooring should be made of wood, concrete, or ceramic tile. If the floor is covered with synthetic material, relative humidity should be at least 30%.
Fast transient/burst IEC 61000-4-4	± 2 kV for electrical power lines ± 1 kV for input/output lines	± 2 kV for electrical power lines ± 1 kV for input/output lines	The quality of the electrical power network should be equivalent to that of a typical commercial or hospital environment.
Surge IEC 61000-4-5	± 1 kV between phases ± 2 kV between phase and earth	± 1 kV between phases ± 2 kV between phase and earth	The quality of the electrical power network should be equivalent to that of a typical commercial or hospital environment.
Voltage dips, short interruptions, and voltage variations IEC 61000-4-11	←-5% UT [→95% voltage dip] during 0.5 cycle 40% UT [60% UT voltage dip] during 5 cycles 70% UT [30 % UT voltage dip] during 25 cycles ←-5% UT [→95% voltage dip] during 5s	←-5% UT [→95% voltage dip] during 0.5 cycle 40 % UT [60% UT voltage dip] during 5 cycles 70% UT [30 % UT voltage dip] during 25 cycles ←-5% UT [→95% voltage dip] during 5s	The quality of the electrical power network should be equivalent to that of a typical commercial or hospital environment. If the CELLU M6® ALLIANCE patient requires operation to continue during power outages, the CELLU M6® ALLIANCE should be powered through an uninterruptible power supply or a battery.
Power frequency magnetic field IEC 61000-4-8	3 A/m	3 A/m	Power frequency magnetic fields should have levels that are characteristic of a typical hospital or commercial environment.

NOTE: UT is the AC voltage prior to the application of the test level.

## → APPENDIX: ELECTROMAGNETIC COMPATIBILITY

TABLE 3: DIRECTIVES AND MANUFACTURER DECLARATION – ELECTROMAGNETIC IMMUNITY – IMMUNITY TESTS

CELLU M6® ALLIANCE is intended for use in the electromagnetic environment specified below. The CELLU M6® ALLIANCE customer or patient should ensure that it is used in such an environment.

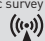
Immunity Test	Test level according to IEC 60601	Conformity level	Electromagnetic environment - directives
Conducted RF disturbances IEC 61000-4-6	3 Veff 150 kHz to 80 MHz	3V	Portable and mobile RF communications devices should not be used closer to any part of the CELLU M6® ALLIANCE, including its cables, than the recommended separation distance, calculated from the applicable equation on transmitter frequency. Recommended separation distance: $d = 1,16\sqrt{P}$ $d = 1,6\sqrt{P}$ 80 MHz à 800MHz $d = 2,33\sqrt{P}$ de 800 MHz à 2,5 GHz where P is the transmitter's maximum power output in watts [W], according to the transmitter's manufacturer, and d is the recommended separation distance in meters [m]. The field strength for fixed RF transmitters, as determined by an electromagnetic survey at site <sup>a</sup> , should be less than the conformity level for each range of frequencies <sup>b</sup> . Interference may be produced near the device marked with the following symbol: 
Perturbations RF rayonnées CEI 61000-4-3	3 V/m De 80 MHz to 2,5 GHz	3 V/m	

NOTE 1: At 80 MHz and 800 MHz, the highest frequency range applies. NOTE 2: These directives may not apply in all situations. Electromagnetic propagation is affected by absorption and by reflections of structures, objects, and people.

<sup>a</sup> The field strength of fixed transmitters, such as radio/telephone (cellular/wireless) base stations and land mobile radios, amateur radios, AM and FM radio broadcasting, and TV broadcasting cannot be theoretically predicted with accuracy. To measure the electromagnetic environment due to fixed RF transmitters, consider performing an electromagnetic survey of the site. If the field strength, measured where the CELLU M6® ALLIANCE is used, exceeds the applicable RF conformity level above, watch the CELLU M6® ALLIANCE to ensure that it is operating as normal. If there is any abnormal performance, additional measures may be necessary, such as reorienting or repositioning the CELLU M6® ALLIANCE.

<sup>b</sup> For the frequency range of 150 kHz to 80 MHz, field strength should be less than 3 V/m.

TABLE 4: RECOMMENDED SEPARATION DISTANCES BETWEEN PORTABLE AND MOBILE RF COMMUNICATION DEVICES AND CELLU M6 ALLIANCE

CELLU M6® ALLIANCE is intended for use in an electromagnetic environment in which radiated RF disturbances are controlled. The CELLU M6® ALLIANCE patient or customer can prevent electromagnetic interference by maintaining a minimal distance between the portable or mobile RF communications device (transmitter) and the CELLU M6® ALLIANCE, as recommended below, based on the maximum transmission power of the communication device.

Maximum rated output of the transmitter W	Separation distance according to the transmitter frequency m		
	150KHz à 80MHz $d=1,2\sqrt{P}$	80MHz à 800MHz $d=1,2\sqrt{P}$	800MHz à 2,5 GHz $d = 2,3\sqrt{P}$
0,01	0,12	0,12	0,23
0,1	0,38	0,38	0,73
1	1,2	1,2	2,3
10	3,8	3,8	7,3
100	12	12	23

For transmitters whose maximum rated output is not shown above, the recommended separation distance d in meters [m] can be estimated using the applicable equation for the transmitter frequency, where P is the transmitter's maximum output in watts [W], according to its manufacturer.

NOTE 1: At 80 MHz and 800 MHz, the separation distance for the highest frequency range applies.

NOTE 2: These directives may not apply in all situations.

Electromagnetic propagation is affected by absorption and by reflections of structures, objects, and people.



## HEADQUARTERS : LPG SYSTEMS S.A.S

TECHNOPARC DE LA PLAINE  
30, RUE DU DR. ABEL - CS 90035  
26902 VALENCE CEDEX 09 - FRANCE  
TEL.: +33 (0)4 75 78 69 00 - FAX: +33 (0)4 75 42 80 85

## INTERNATIONAL/MARKETING

ECOLUCIOLES – BAT A  
955 RTE DES LUCIOLES – BP 243 – 06905 SOPHIA-ANTIPOLIS – FRANCE  
TEL.: +33 (0)4 92 38 39 00 – FAKS: +33 (0)4 92 96 09 65

수입업체 상호:

에머고코리아유한회사

수입업체 주소:

서울특별시 강남구 테헤란로 152 강남파미연스센터 26층

IMPORTER NAME:

Emergo Korea Ltd

IMPORTER ADDRESS:

26F, 152, Teheran-ro, Gangnam-gu, Seoul, 06236, Rep. of KOREA

